

Series 3000 Thermal MultiPlane— the versatility of standard storefront systems with improved thermal performance

The Series 3000 Thermal MultiPlane extends the versatility of standard storefront systems by offering **improved thermal performance** and multiple glass plane options. The Series 3000 provides more options for head and sill anchorage, **structural silicone glazing** and a front set installation option utilizing continuous head and sill members. Designed for 1" infill, Series 3000 Thermal MultiPlane has available glazing adapters and gasket options for infills ranging from 1/4" to 1-1/8".

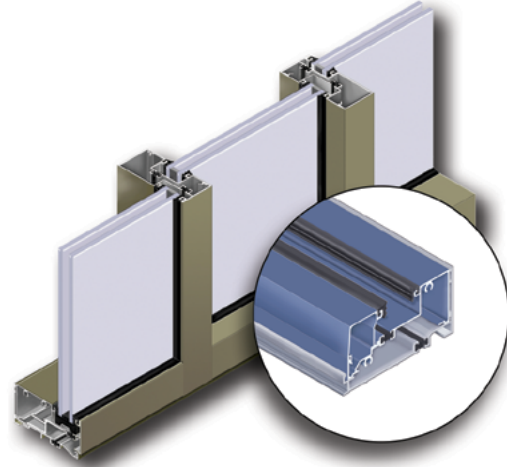

First Community Credit Union, St. Louis, MO
Architect: TR,i Architects

Features

- Overall system dimensions: 2" x 4-1/2"
- Front Set, Center Set, Back Set or Multi-set glazing configurations
- Optional sill receptor requires no additional anchoring of sill member
- Optional thermally broken head anchor clip
- SSG glazing with patented funnel bridge
- Continuous head and sill assembly option for front set
- Screw spline and shear block assembly
- Outside and inside glazing options
- Complete 90° and 135° corners
- High sidelite base
- Thermally broken members with polyurethane thermal breaks
- Accommodates ZS-2750 vents
- Factory painted Kynar 500®/Hylar 5000® finishes, meeting all provisions of AAMA 2605
- Factory anodized finishing



Product Details

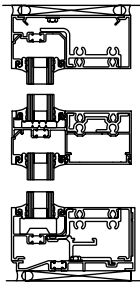

Front Set

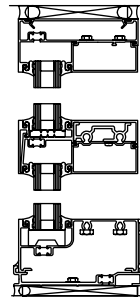
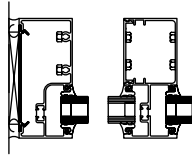

Front Set SSG

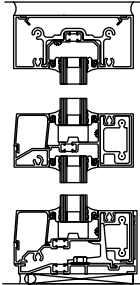
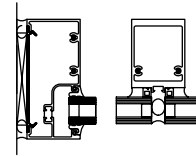

Center Set

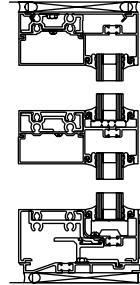
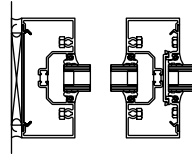

Back Set

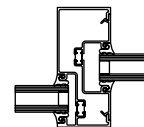
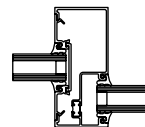
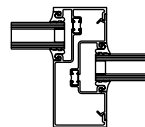
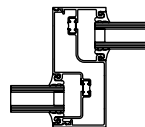
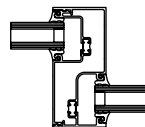
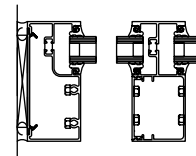

Multi-Set

Performance

Air Infiltration	<.06 CFM/SQ FT (6.24 PSF) per ASTM E283
Static Water	10 PSF per ATSM E331
Deflection Load	40 PSF per ASTM E330
Structural Load	60 PSF per ASTM E330
STC	
32 (1/4" - 1/2" - 1/4" glazing) -	Center and Front Set
37 (1/4" laminated - 1/2" - 1/4" laminated glazing) -	Center Set
38 (1/4" laminated - 1/2" - 1/4" laminated glazing) -	Front Set
High-performance per AAMA 1503 for Clear 1" Insulating Glass:	
U-Factor = 0.54, CRF frame = 69	Front Set
U-Factor = 0.56, CRF frame = 58	Center Set
U-Factor = 0.51, CRF frame = 57	Back Set
NFRC Tested and Certified	

Kynar 500® is a registered trademark of Atofina
 Hylar 5000® is a registered trademark of Ausimont USA, Inc.